

# FS-1



## Frosty Swirl Machine

Ice Cream, Yogurt, Milk shake & Fruit Blender

### Product Offering

Offer all popular flavors soft serve, milk shake, fruit smoothies and juice.

### All in ONE

Simply put ice cream or yogurt in the mixing cone and add customers' selection of blending treats. The machine will easily and quickly swirl ice cream, yogurt, milk shake, fruit smoothies and juice with candies, fruits, nuts, or cookies to create an infinite variety of flavor delights.

### Feature

- Power ON water wash reduces cycle time and labor costs. Designed with water switch located in the actuating handle for convenient one handed operation.
- Mix liquids with closed mixing bowl until dispensed by opening the built-in gate valve in the discharge nozzle.
- Makes delicious Juice, Milk Shakes, Ice Cream and Yogurt.
- Hard ice cream or frozen yogurt can be mixed into ingredients.
- All moving parts are reinforced and supported with ball bearing construction to provide years of trouble free service.
- Special operating handle design provides the greatest leverage when needed most as the auger enters the cone and begins the mixing process. The ease of operation will be appreciated by everyone.
- Spring loaded bayonet mount auger is easy to remove or install.
- Safety sensor switch deactivates the machine when protective cover is removed so that accidental startup cannot occur.



50 Hz.  
Models

MODEL FS-1

#### SPACEMAN ICE SYSTEMS (HK) CO, LIMITED

FACTORY: YUANYI RD, INDUSTRY PARK, SANQISHI TOWN, YUYAO, ZHEJIANG, CHINA 315412

PHONE: +86 574 62953030

FAX: +86 574 62951664

www.spaceman-company.com

Email: info@spaceman-company.com

ISO 9001: 2008  
Registered Firm

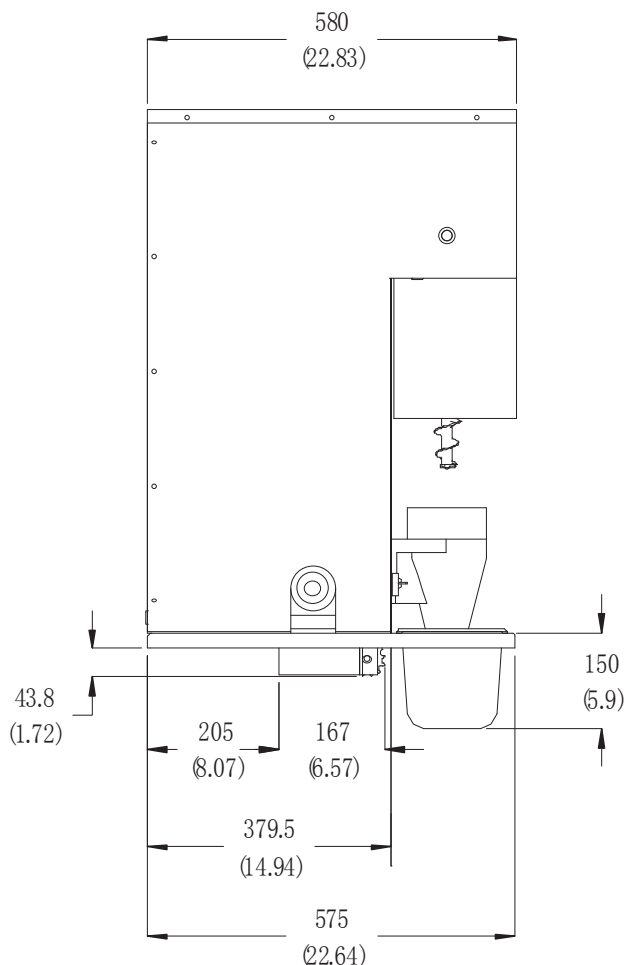
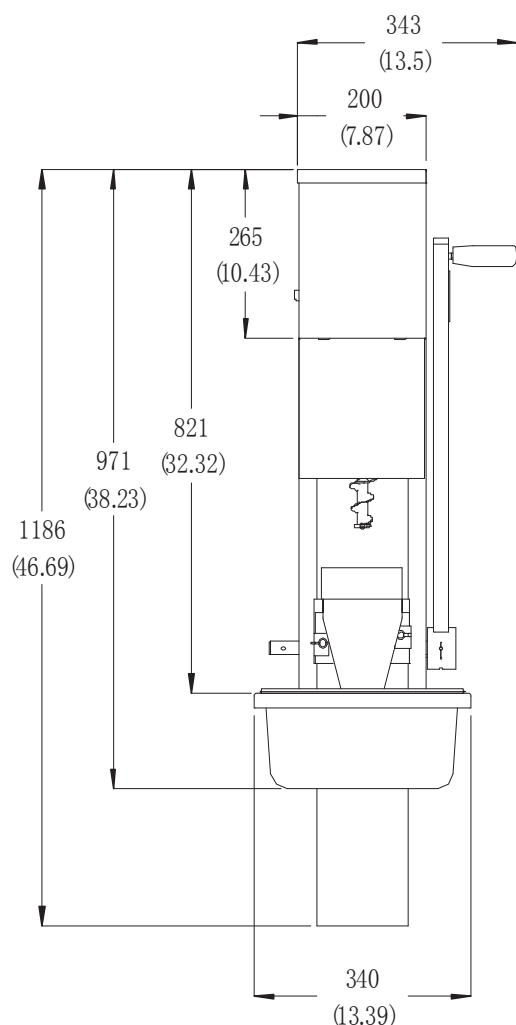

Weight	Kg / lb
Net	76 / 168
Shipping	89 / 196

<b>Packaging Volume</b>	0.28 CBM / 9.77 CBF
-------------------------	---------------------

Dimensions	Net (mm/in)	Shipping (mm/in)
Width	340 / 13.4	405 / 15.9
Depth	575 / 22.6	663 / 26.1
Height	971 / 38.2	1030 / 40.6

#### Note

Continuing research results in steady improvements, therefore, these specifications are subject to change without notice.

## Specifications

### Electrical

Unit shall be cord connected or permanently connected. Consult your local Spaceman distributor for available cord & receptacle specifications as per local codes.

### Motor

One, 1.25HP

### Water connection

Water inlet connection is on back of chassis..  
Water drain connection is under the chassis..